

## VLXT-06C.I.JP

Gigabit Ethernet, 0,5 Megapixel, Color

Article number: 11701719

### Overview

- 800 × 608 px
- Sony IMX426
- 1/1.7" CMOS
- 1622 fps
- 10 GigE
- JPEG



Picture similar



GEN*i*CAM



### Technical data

#### Sensor information

Sensor	Sony IMX426 Gen3
Mono/Color	Color
Sensor type	1/1.7" CMOS
Shutter type	Global shutter
Resolution	800 × 608 px
Pixel size	9 × 9 μm
Exposure time	0.001 ... 60000 ms

#### Data quality (EMVA 1288 typical)

Dark noise	23.29 e-
Saturation capacity	1201984 e-
Dynamic range	72.2 dB
Signal-to-noise ratio	50.1 dB
Quantum efficiency	53.2 % @ 465 nm 63.4 % @ 536 nm 61 % @ 631 nm

#### Acquisition formats

Image formats, interface frame rate max.	Full Frame, 800 × 608 px, max. 1622 fps Binning 2×2, 400 × 304 px, max. 1622 fps Binning 2×1, 400 × 608 px, max. 1622 fps Binning 1×2, 800 × 304 px, max. 1622 fps
Image formats, acquisition frame rate max. (Burst Mode)	Full Frame, 800 × 608 px, max. 1622 fps

#### Acquisition formats

Pixel formats	BayerRG8 BayerRG10 BayerRG12 BayerRG12 Packed Mono8 Mono10 Mono12 Mono12 Packed RGB8 BGR8
---------------	--

#### Image preprocessing

Analog controls	Gain (0 ... 48 dB) Offset (0 ... 255 LSB 12 Bit)
-----------------	---

Color models	Mono Raw Bayer RGB BGR
--------------	---------------------------------

Image processing	JPEG
------------------	------

#### Camera features

Basic Functions	Exposure Gain / Color Gain Free Running Mode (Live Image) Trigger / Exposure Active (Flash) Binning 2x2 Partial Scan Offset
-----------------	---

# VLXT-06C.I.JP

Gigabit Ethernet, 0,5 Megapixel, Color

Article number: 11701719

## Technical data

### Camera features

Auto Functions	Exposure Auto Gain Auto White Balance Auto Color Transformation Auto
Image Pre-processing	Image Flipping (X/Y) Color Processing (RGB, BGR, Mono) Color Enhancement (with optimized ColorTransformationMatrix) LUT / Gamma JPEG Image Compression
Acquisition / Interface	Burst Mode Adjustable Framerate Short Exposure Time Enable Device Link Throughput Limit Internal Image Buffer
Synchronization	free running trigger Sequencer
Trigger sources	Hardware Software ActionCommand
Trigger delay	0 ... 2 sec, tracking and buffering of up to 256 trigger signals
Process Synchronization	Events Timer Trigger Delay Debouncer Counter Sequencer Trigger via Action CMD (GigE) Action CMD Request ID Trigger ID inside Chunk Additional Output Modes (e.g. Trigger Ready) PWM (PWM Duration / PWM Duty Cycle) Selectable Output format (e.g. Tri State, Push Pull) Chunk data inside transferred image Encoder support via Counter End trigger source 4 power outputs with up to 120 W (max. 48 V / 2.5 A)
Time synchronization IEEE 1588	IEEE 1588 / Master and Slave function IEEE 1588 / Scheduled Action CMD IEEE 1588 / Synchronized Acquisition Framerate
Additional Functions	User Set Integrated temperature sensor Readable additional information (e.g. sensor information) Save Custom Data
Lens control	Corning liquid lens
Sequencer	Automated control for series of images using different sets of parameters

### Camera features

Sequencer parameter	output line Exposure time gain factor ROI Offset x ROI Offset y
Internal image buffer	1024 MB 2137 images (Trigger Mode) 1 image (Free Running Mode)

### Interfaces and connectors

Data interface	10 Gigabit Ethernet, Transfer rate 10000 Mbits/sec, Gigabit Ethernet, Transfer rate 1000 Mbits/sec, Fast Ethernet, Transfer rate 100 Mbits/sec, Connector: M12 / 8-pol x-coded (SACC-CI-M12FS-8CON-L180-10G)
Process interface	M12 / 12 pins a-coded (SACC-CI-M12MS-12CON-L180)
Power supply	via M12/12 pins a-coded

### Mechanical data

Lens mount	C-mount
Width	60 mm
Height	60 mm
Depth	99.7 mm
Weight	≤ 485 g
Material	aluminum

### Electrical data

Voltage supply range +Vs	19.2 ... 28.8 V DC (external power supply)
Power consumption	Approx. 11.7 W @ 24 VDC and 1622.0 fps

### Non-volatile memory

Flash memory size	128 kB
-------------------	--------

### Environmental conditions

Operating temperature	0 ... +60 ° @ T = measurement point
Humidity	10 ... 90 % (non-condensing)
Protection class	IP 40 IP 54 (with mounted tube and cable) IP 65 (with mounted tube and cable) IP 67 (with mounted tube and cable)

### Digital I/Os

Lines	2 input lines 4 power output lines with pulse width modulation (PWM) (max. 48 V / max. 2,5 A) RS232
-------	---

### Conformity

Conformity	CE RoHS EAC KC (R-R-BkR-VLXT-71MI) UL recognized
------------	--

# VLXT-06C.I.JP

Gigabit Ethernet, 0,5 Megapixel, Color

Article number: 11701719

## Dimension drawing



## Principle

Optional accessories for protection class IP 65/67:

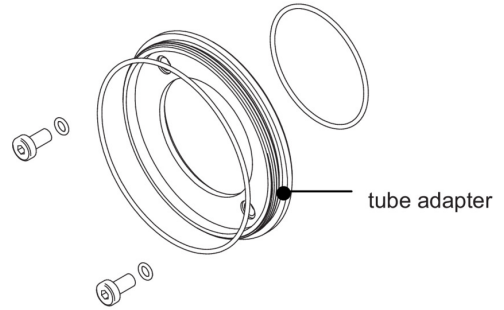

tube adapter

- hard-anodized, incl. sealing and screws  
 $\varnothing$  49,5 mm (VCXG.I 11185373)  
 $\varnothing$  65 mm (VCXG.I 11185377)  
 $\varnothing$  95 mm (VCXG.I 11704311)  
 $\varnothing$  65 mm (VLXT 11193125)  
 $\varnothing$  95 mm (VLXT.EF 11704315)

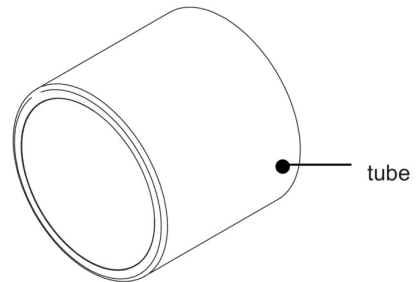

tube

- hard-anodized, cover glass PMMA  
 $\varnothing$  49,5 mm, Length 44 mm (11185370)  
 $\varnothing$  65 mm, Length 58 mm (11185374)  
 $\varnothing$  95 mm, length 70 mm (11704312)
- hard-anodized, tempered laminated safety glass  
 $\varnothing$  49,5 mm, Length 44 mm (11701124)  
 $\varnothing$  65 mm, Length 58 mm (11701125)